

Parcel Owner Mailing
 16-10-25-0000-0260-0000
 MARY ELIZABETH CHURCH
 C/O JERRY CLEVINGER
 5063 HIGHWAY 17 S
 GREEN COVE SPRINGS, FL 32043-4926

911 Description
 122 VIRGINIA LN, PALATKA 32177 [314]
 PT OF NW1/4 OF NW1/4 OR42 P109, (EX OR108 P132 RD)+OR638 P620, (CHURCH AND CEMETERY)

Orig Parcel

Parcel Sales Data							
Book	Page	Instrument	Month	Year	QSCD	Price	
0638	0620	WD	Dec	1993	01 V	\$300	
0130	0588	WD	Sep	1964	01 V	\$100	

Outbuildings and Extra Features								
Line	Code	Units	Length	Width	Sq Ft	Rate	Value	
1	001-03C		270	1	270	1	270	
2	141-03C		520	1	520	3	1,560	
3	141-03C		83	1	83	3	250	
4	DUTU-04C		6	6	36	6	220	
5								
6								
7								
8								
9								
10								
11								
12								
13								
14								
15								
16								
17								
18								
19								
20								
Total 2,300								

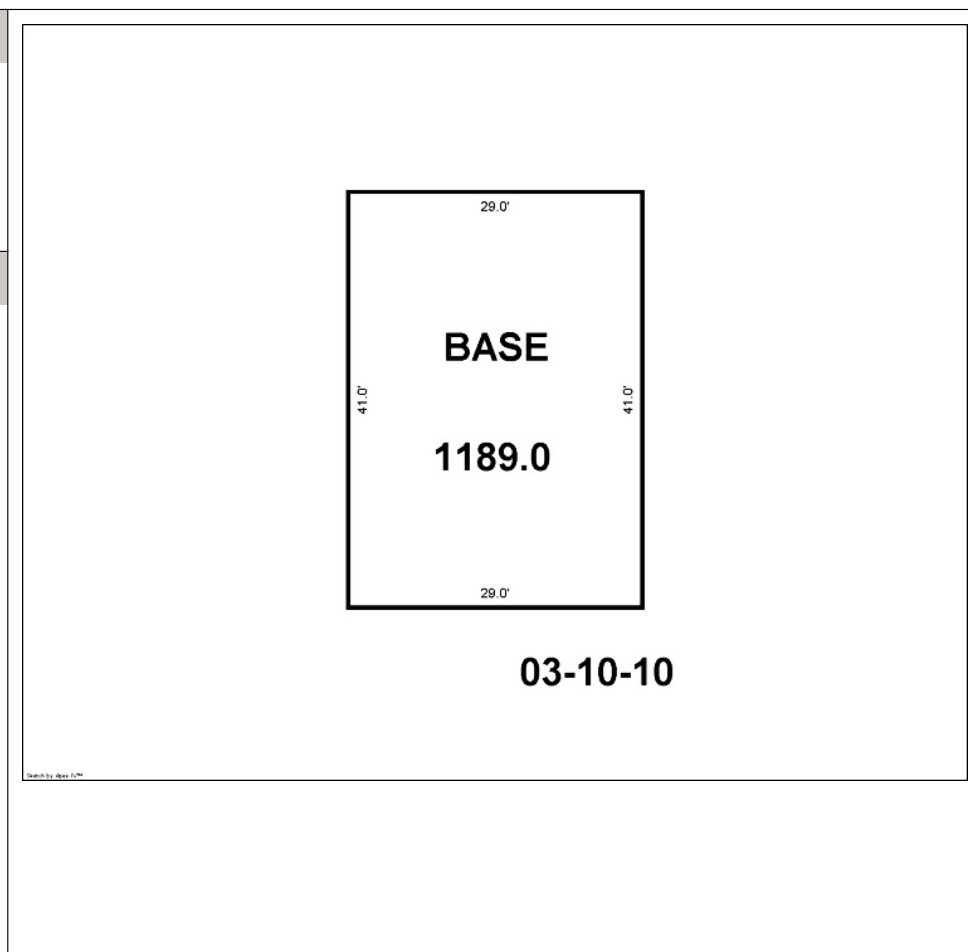

Exemption	Amount	Remainder	Owner %	Applied To
WHX	\$50,870	\$0		All Districts

Improvement Value	Amount	Use Code	Value
OBXF Value	\$2,300	07100	
Land Value	\$8,130	Improvements	1
Market Value	\$50,870	Location	Putnam County
Just Value CU		Total Acres	0.80
CU Value		Zoning	R-2
Market Adjusted	\$50,870	FLUM	RC

Parcel Value Breakdown			
Taxing District	Assessed Limited	Minus(-) Exemptions	Taxable Value
St Johns River WMD	\$50,870	\$50,870	\$0
Fire MSTU	\$50,870	\$50,870	\$0
County	\$50,870	\$50,870	\$0
School	\$50,870	\$50,870	\$0

Primary Improvement										Improvement Area & Additions				
Desc	Church	Title No.	Substructure	01 - Continuous	Cabinet & Mill	04 - Minimum	Desc	% Rate	Rate	Sq Ft	Cost			
Class	B	Model	Floor System	01 - Slab on Grade	Floor Finish	08 - Carpeting 2	B00	100	82.46	1,189	98,045			
Type	0	RP No. or Tag	Exterior Walls	01 - Conc. Block/Board	Interior Finish	10 - Ceiling Only - Min								
Adj Base Rate	82.46	Length	Height In Feet	10	Paint & Decor	03 - Average								
Base Sq Ft	1,189	Width	Party Wall %		Plumbing Fixt	7.0								
% Good	41.25	Lot #	Sub Frame	05 - Wood Beam - Columns	Bath Tile	05 - Floor Only								
Quality	1.00	Bed/Bath	Roof Framing	06 - Wood Frame/Truss (COM)	Heating & Air	01 - Heating-Cooling Ducts								
		Attachments	Roof Cover	07 - Galv. Sheet - V Crimp	Electrical	03 - Average								
		Account	Bed/Bath	/ 2	Corners	4.0								
Total Replacement Cost 98,045														

Land Lines														
Line	Code	Depth Chart	Depth In Feet	Corner Factor	Depth Factor	Cond	Unit Price	Adj Unit Price	Units	Just Value	CU Unit Price	CU Value	Just Value CU	Taxable Value
1	001C	1	296	100%	125%		65	81	100					8,130
2														
3														
4														
5														
6														
Total										0	0	0	8,130	

NOTICE: This is an interim Putnam County file. Property assessment information is subject to change until it is certified in October.