

Parcel Owner Mailing
 35-10-23-0000-0390-0000
 COMMUNITY CHURCH OF GOD OF JOHNSON
 C/O ROBERT W DOWLING
 147 VAUSE LAKE RD
 HAWTHORNE, FL 32640

911 Description
 423 S COUNTY RD 21, HAWTHORNE 32640 [309]
 35-10-23 PT OF SW 1/4 OF NW, 1/4 BK 156
 P 445

Orig Parcel

Parcel Sales Data							
Book	Page	Instrument	Month	Year	QSCD	Price	
0701	0114	RESO	May	1996		\$0	
0701	0112	AOA	May	1996		\$0	
0701	0106	WD	May	1996	02 I	\$56,000	
0365	1897	WD	Sep	1978		\$5,000	

Outbuildings and Extra Features								
Line	Code	Units	Length	Width	Sq Ft	Rate	Value	
1	001-03C		160	1	160	1	160	
2	058-02C	2				50	100	
3	DUTU-03C		12	10	120	4	480	
4	DUTU-03C		10	19	190	4	760	
5								
6								
7								
8								
9								
10								
11								
12								
13								
14								
15								
16								
17								
18								
19								
20								

Exemption	Amount	Remainder	Owner %	Applied To
WHX	\$266,000	\$0		All Districts

Improvement Value	\$295,780	Use Code	07100
OBXF Value	\$1,500	Improvements	2
Land Value	\$7,090	Location	Putnam County
Market Value	\$304,370	Total Acres	0.38
Just Value CU		Zoning	AG
CU Value		FLUM	A2
Market Adjusted	\$304,370		

Parcel Value Breakdown			
Taxing District	Assessed Limited	Minus(-) Exemptions	Taxable Value
County	\$266,000	\$266,000	\$0
Fire MSTU	\$266,000	\$266,000	\$0
St Johns River WMD	\$266,000	\$266,000	\$0
School	\$304,370	\$304,370	\$0

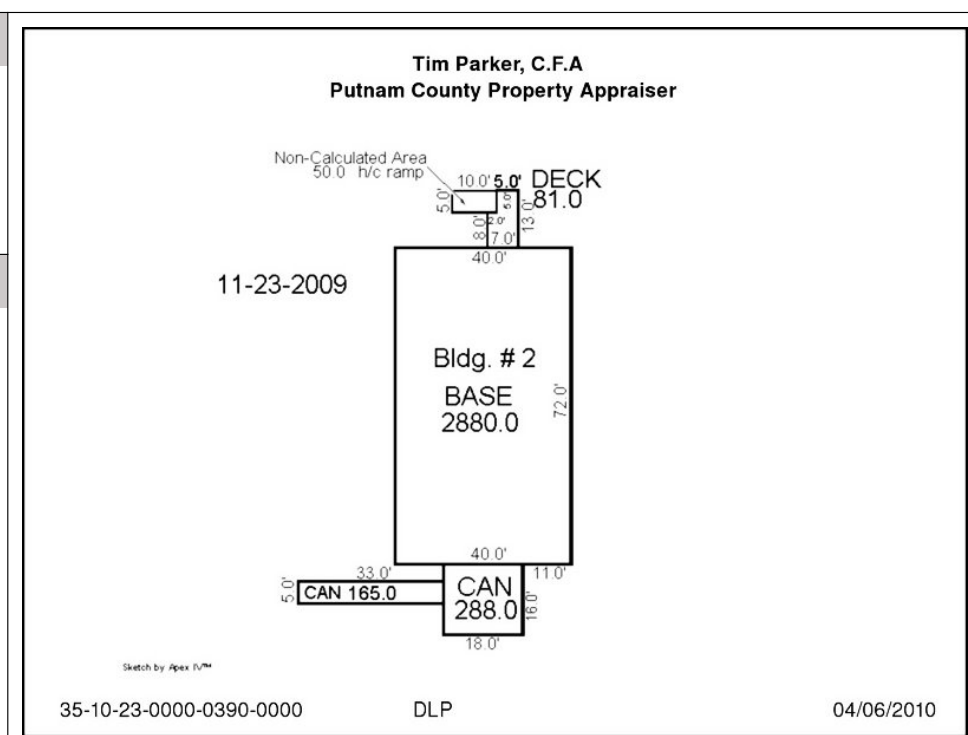

Total 1,500

Primary Improvement										Improvement Area & Additions				
Desc	Church	Title No.	Substructure	02 - Piers	Cabinet & Mill	04 - Minimum	Desc	% Rate	Rate	Sq Ft	Cost			
Class	B	Model	Floor System	03 - Wood W/Sub Floor	Floor Finish	05 - Pine/Soft Wood	B00	100	90.27	1,120	101,102			
Type	0	RP No. or Tag	Exterior Walls	03 - Shingle / Wd Sd. - Avg.	Interior Finish	01 - Furred - Plastered	OPF	35	31.59	192	6,048			
Adj Base Rate	90.27	Length	Height In Feet	12	Paint & Decor	02 - Above Average								
Base Sq Ft	1,120	Width	Party Wall %		Plumbing Fixt	5								
% Good	58.75	Lot #	Sub Frame	05 - Wood Beam - Columns	Bath Tile	05 - Floor Only								
Quality	1.00	Bed/Bath	Roof Framing	03 - Gable/Hip (RES)	Heating & Air	11 - Heat Pump								
		Attachments	Roof Cover	13 - Pre Finished Metal	Electrical	03 - Average								
		Account	Bed/Bath	/ 0	Corners	4								
											Total Replacement Cost 107,150			

Land Lines														
Line	Code	Depth Chart	Depth In Feet	Corner Factor	Depth Factor	Cond	Unit Price	Adj Unit Price	Units	Just Value	CU Unit Price	CU Value	Just Value CU	Taxable Value
1	010C	1	163	100%	109%		50	55	130					7,090
2														
3														
4														
5														
6														
Total										0	0	0	7,090	

NOTICE: This is an interim Putnam County file. Property assessment information is subject to change until it is certified in October.

